

REV.	ECN NO.	DESCRIPTION	DRAW	APPD.	DATE
A	---				

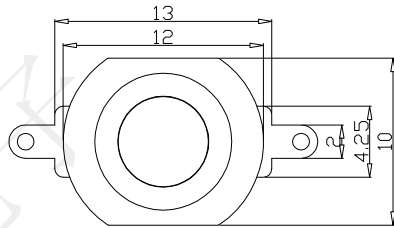

ON-OFF

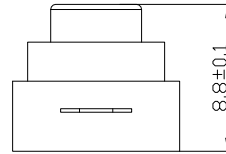
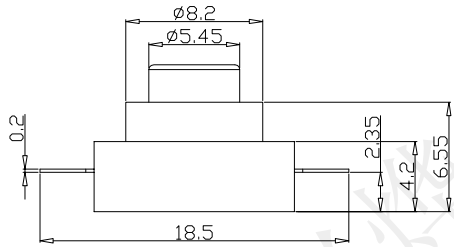
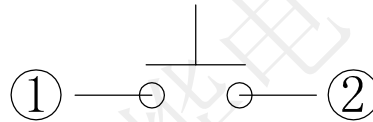

电路简图



受控文件

SPECIFICATION:
 Operating temperature: -25 °C~70 °C
 Rated loading: DC 5V 200mA
 Contact resistance: 100mΩ Max
 Insulation resistance: 100MΩ Min
 Withstanding voltage: AC: 500V (50Hz) /min
 Operating force: 700±50gf Max
 Electrical Life: 500000 cycles

		Series Name :	
		Product Description : XY-1210-A 手电筒开关	
TOLERANCE		APPD: 陈爱光	
X.X ±0.30	X.° ±2°	CHED: 施立敏	
.XX ±0.20	X° ±1°	DRAW: 马洪飞	
.XXX ±0.10	.XX° ±0.5°		
UNITS	mm		SCALE SHEET REV. 1:1 1/1 A1