

L: 1.0、1.5、2.0

REV:	ECN NO.	DESCRIPTION	DRAW	APPD	DATE
A	---				

P. C. B MOUNTING PATTERN DIMENSION

the following soldering are recommended for reflow soldering

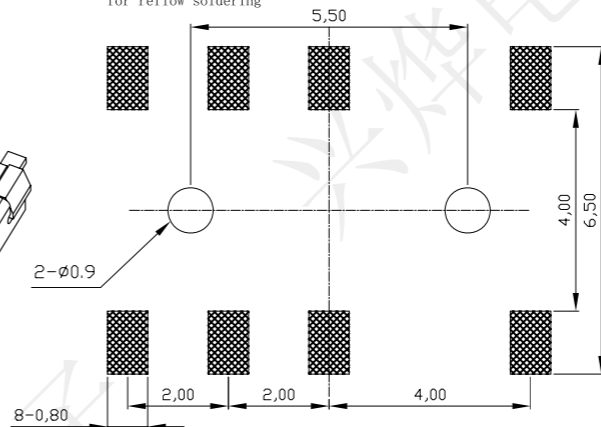

CIRCUIT DIAGRAM

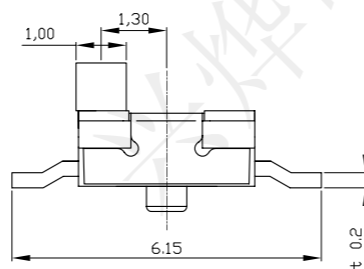
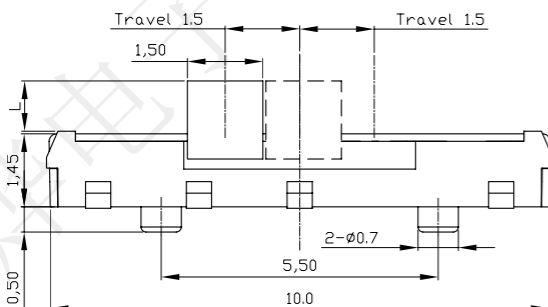
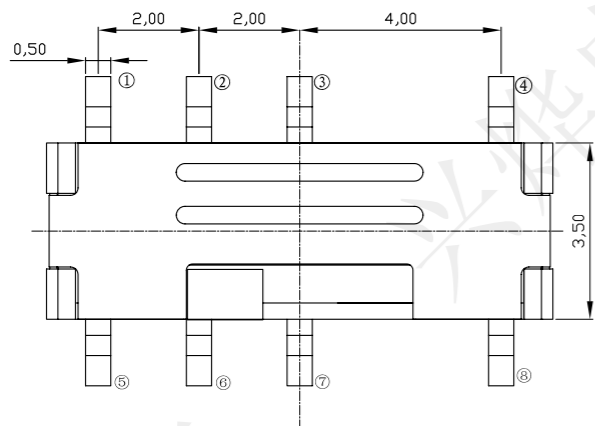
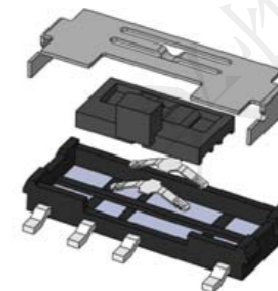
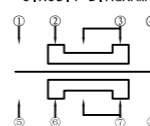

SPECIFICATION:

- Operating temperature: -16 °C~60 °C
- Rated loading: DC 4V 0.3A
- Contact resistance: 70mΩ Max
- Insulation resistance: 100MΩ Min
- Withstanding voltage: AC 250V (50-60Hz) /min
- Electrical Life: 10000 cycles
- Operations Force : 1.96±0.98N (200±100gf)
- Travel to closure: 1.5±0.1mm

受控文件

5	盖板	不锈钢	1	本色
4	手柄	PPA	1	黑色
3	簧片	铍青铜镀银	1	银白色
2	基座	LCP	1	黑色
1	端子	黄铜镀银	1	银白色
NO.	PARTS	MATERIAL	QTY.	FINISHING

深圳市兴烨电子有限公司  
ShenZhen Xing Ye Electronics co., Ltd

TOLERANCE		APPD: 陈爱光 CHED: 施立敏 DRAW: 马洪飞
X.X	±0.30 X° ±2°	
.XX	±0.20 .X° ±1°	
.XXX	±0.10 .XX° ±0.5°	
UNITS	mm	

Series Name :		
Product Name : MSS-23C02中八脚贴片有柱		
Part NO: SKL20027		
	SCALE	SHEET
	1:1	1/1
		REV. A1

REV.	ECN NO.	DESCRIPTION	DRAW	APPD	DATE
A	---				

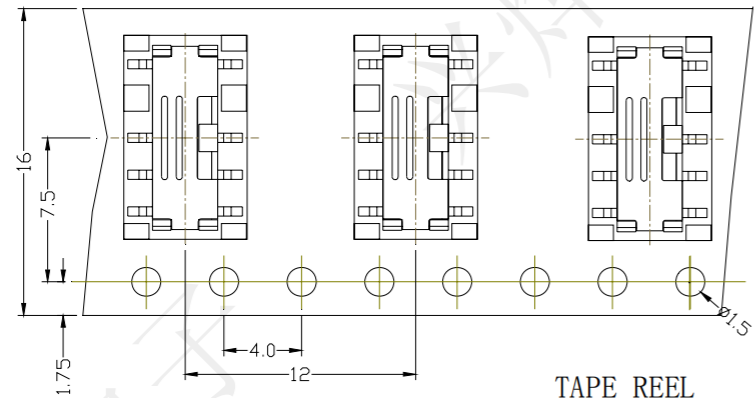

TAPE REEL  
SCALE 1:1

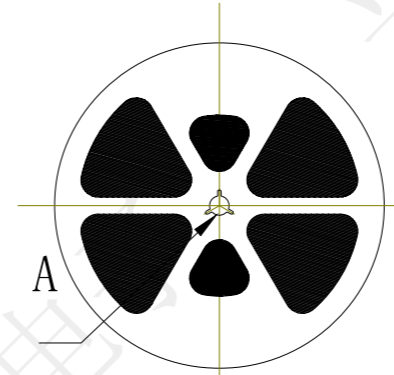
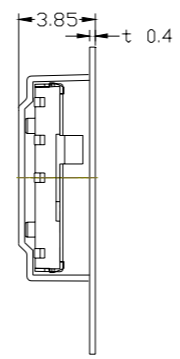

备注：  
成品每卷包装数量：1500PCS/卷。

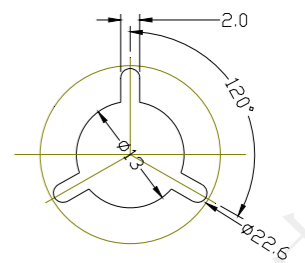
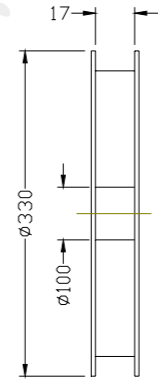

DETAIL A  
SCALE 1:1

<b>深圳市兴烨电子有限公司</b> ShenZhen Xing Ye Electronics co., Ltd		Series Name :								
		Product Name : MSS-23C02中八脚贴片有柱								
TOLERANCE		APPD: 陈爱光		Part NO: SKL20027						
X.X	±0.30	X.°	±2°	<table border="1"> <tr> <td>SCALE</td> <td>SHEET</td> <td>REV.</td> </tr> <tr> <td>1:1</td> <td>1/1</td> <td>A1</td> </tr> </table>	SCALE	SHEET	REV.	1:1	1/1	A1
SCALE	SHEET	REV.								
1:1	1/1	A1								
.XX	±0.20	.X°	±1°							
.XXX	±0.10	.XX°	±0.5°							
UNITS	mm	DRAW: 马洪飞								